

C. For outdoor use: If the street lamp is used outdoor, please pay special attention (see series figures a-e as shown below):

- Please screw the nut at top of lamp holder tightly.
- All connection points ① and ②, ③ and ④, ⑤ and ⑥, ⑦ or ⑧ and respective lamp holder must be screwed tightly to avoid water and electricity leakage!
- The adapter itself is not waterproof, and it is required to ensure that the connecting point between adapter and main power shall be located in indoor place free from rain and snow, so as to avoid the electricity leakage or electric shock risk!
- The two ends of lamp support are arranged with drip hole, and please ensure that the hole is unobstructed;
- It only can be used outdoor for Sunny day.

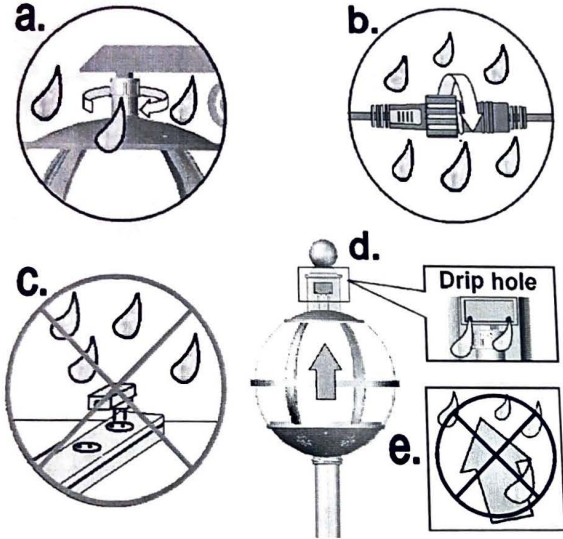

D. Examination: The bottom of each lamp holder is arranged with a switch (as shown below). One of the lamp holders can play music, and the music is controlled by its switch (left figure); when the switch is placed at left, it is able to see the shining light and flying snowflake in this lamp holder, with music played. If the above-mentioned function can't be found, it is required to check whether all connecting points ① and ②, ③ and ④, ⑤ and ⑥, ⑦ (or ⑧) are connected well with its lamp holder, or ask the experienced engineer to give an examination, until the above-mentioned function is realized. You can also place this switch at right to close music according to your own demand. Another lamp holder has the same function as the above lamp holder except that it can not play music, and its switch function is shown in right figure.



5. Decorate and enjoy

As shown in the figure below, fix the brand (16) and the wreath + bowknot (17) to the upper side of the lamp post to make the street lamp beautiful. If the street lamp is to be installed outside, to avoid wind and rain, there is no need to install these decorations. That's all of the installation steps. Now you can enjoy this type of snowing and musical street lamp visually and acoustically.

